

CORNER RESTORATION

C1/4 COR.
 CORNERS Sec. 1 TWP 9 S. RANGE 27 E.

ORIGINAL SURVEY BY: W.F. White, Deputy County Surveyor
 CONTRACT NUMBER: Survey recorded in Surveyor's Record Book 1, Page 6
 CONTRACT DATE: April 5, 1895

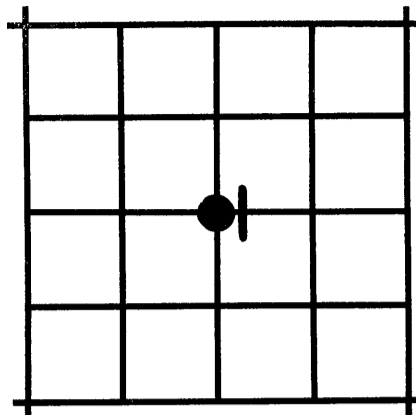

ORIGINAL DESCRIPTION: at intersection of ranged lines I placed a stone 8x9x14 inches marked 1/16 CS for centre of section and buried broken glass bottles 18 inches deep beneath stone." Subsequently, L.E. Lucas, Deputy County Surveyor, found this stone marked 1/4 CS on March 26, 1921, as recorded in Surveyor's Record Book 2, Page 14.

RESTORATION BY, STAMP AND DATE:

R.D. Bagett
 J.L. Watson
 Van Richards, Mayor of Monument

REGISTERED
PROFESSIONAL
LAND SURVEYOR

Robert D. Bagett
 OREGON
 JULY 12, 1963
 ROBERT D. BAGETT
 598

Grant County Surveyor

May 28, 1992

EVIDENCE FOUND: At the corner point I found a 3/4" x 30" iron pipe with it's top just under the surface of Main Street, we referenced the top of this pipe, we excavated, finding that the pipe was driven in at a slant. Vertically beneath the top of the pipe and down about 24 inches we found a basalt river stone 13x9x8 inches marked 1/4 CS.

**RECEIVED AND
FILED**

JUL 13 1992

OFFICE OF COUNTY SURVEYOR
Robert D. Bagett
 Attest: *[Signature]*

**DESCRIPTION OF MONUMENTS AND ACCESSORIES SET AND METHODS USED:
 Show how trees are scribed and basis of bearings, including compass var.**

At the corner point: I set a 5/8"x24" copper sleeved iron rod, 32" in the ground, with attached 2 1/2" Grant County Surveyor brass cap marked as shown. From which I SET NEW REFERENCE POINTS:
 The NW corner of a stucco cafe building bears N.44°30'E 57.05 feet.
 A 1/4"x 1-1/2" PK nail, set in construction seam in top of 8" concrete curb bears S.56°40'E., 30.22 ft.
 A 1" cross chiseled in near face at bottom of a 1-1/2" x 36" steel fence post, set in NE corner of 8" conc. retaining wall bears S.27°10'W., 64.76 ft.
 A 1/4"x 1-1/2" PK nail set at construction seam on east side of conc. curb & storm drain bears N.30°17'W., 36.22 ft.

MONUMENT MARKED

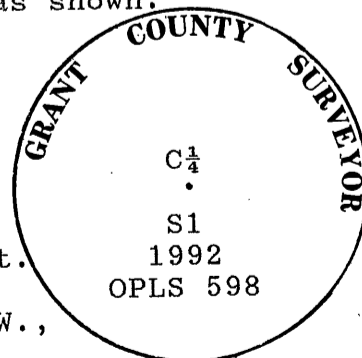

Buried corner stone 4 ft. deep and centered under the rod and placed old iron pipe east and alongside stone and poured concrete in hole to top of brass cap. We then placed a cast iron monument box & cover flush with the street over the brass cap and poured concrete around monument box. The brass cap is about 8 inches below the paved surface of Main Street and approximately in center of street.